

MARIAN UNIVERSITY®

# Marian University Transition Scholarship

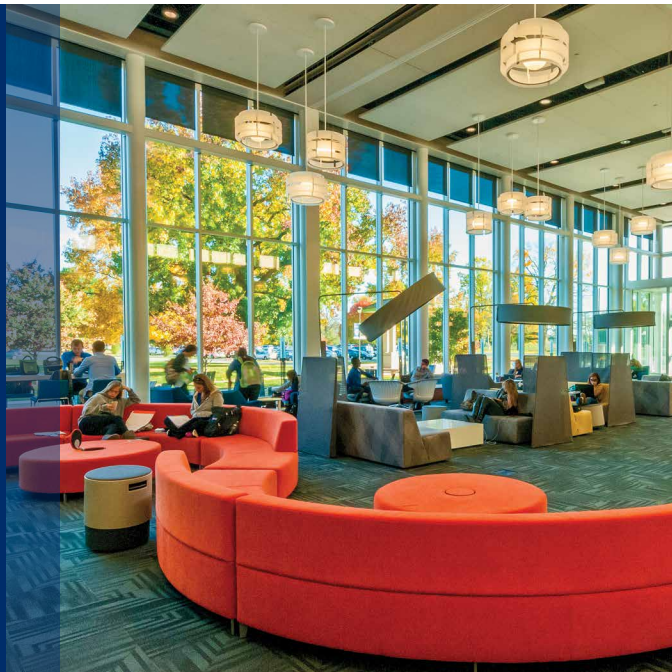

After completing your associate degree at Marian University's Ancilla College, transition to the Marian University Indianapolis campus to pursue your bachelor's degree.

## SCHOLARSHIP CRITERIA

- ➔ Must earn an associate degree from Marian University's Ancilla College.
- ➔ Must continue your education the following semester.

## Scholarship Details

The award amount for 2022 totals up to \$17,750 per year, reaching a maximum total of \$35,500\* over four consecutive semesters after transition.



\*Amount to vary based on cost difference between Marian University Indianapolis and Marian University's Ancilla College.

## Marian University Indianapolis Bachelor's Programs

Students who earn an associate degree at Marian University's Ancilla College take courses needed to earn a bachelor's degree from Marian University Indianapolis. Students seeking to continue their education seamlessly advance within Marian University and credits are accepted towards their bachelor's degree.

## MARIAN UNIVERSITY INDIANAPOLIS FAST FACTS

39 MAJORS 46 MINORS 30 SPECIALIZATIONS

13:1 STUDENT-TO-FACULTY RATIO



184 FULL-TIME PROFESSORS

## Questions?

Contact the Office of Financial Aid at 317.955.6040 or [finaid@marian.edu](mailto:finaid@marian.edu).

3200 Cold Spring Road  
Indianapolis, IN 46222-1997

[marian.edu/ancilla](http://marian.edu/ancilla) |    

Marian University is sponsored by the Sisters of St. Francis, Oldenburg, Indiana.

JUL. 2022